



# DIRECT BURY POLE

## EOS 1000 SERIES (EPA:10)



- Max EPA: 10
- Material: Fiberglass
- Non-conductive
- Non-corrosive
- Compliant with NAAMM & AASHTO

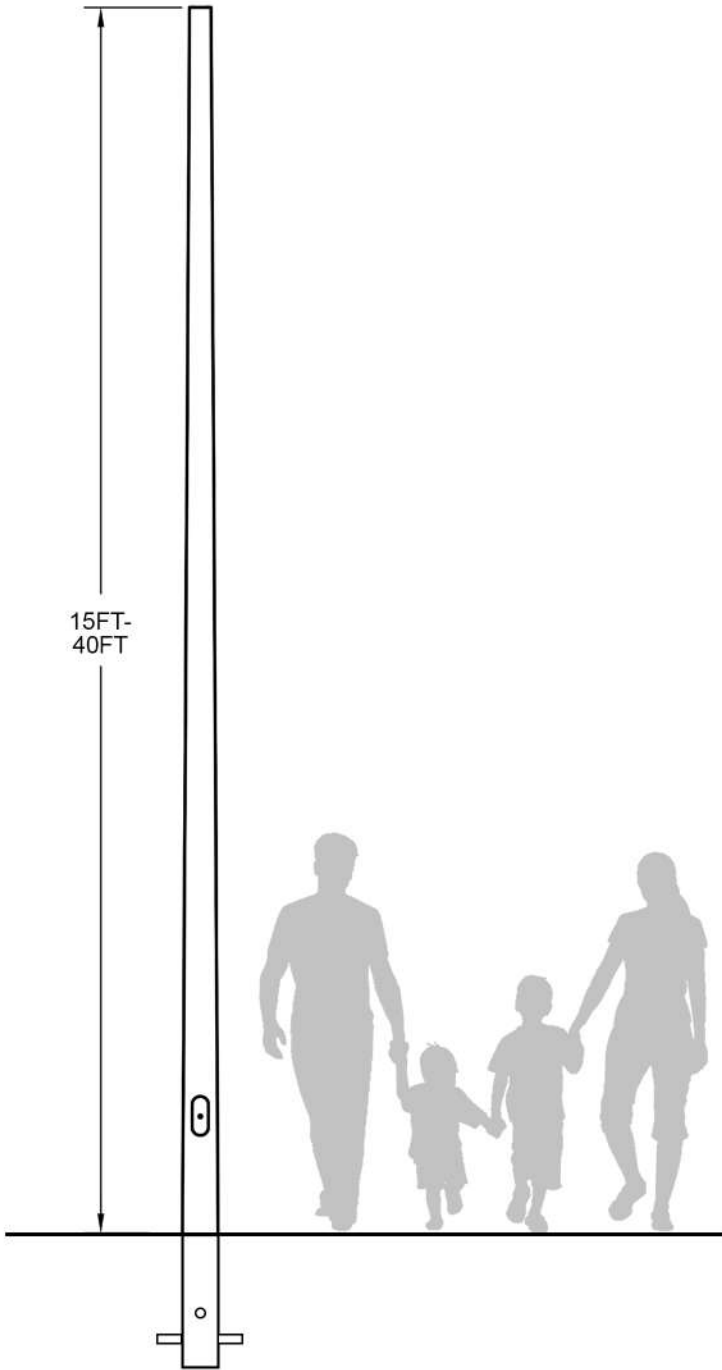

\*Do not scale drawing

### HANDHOLE

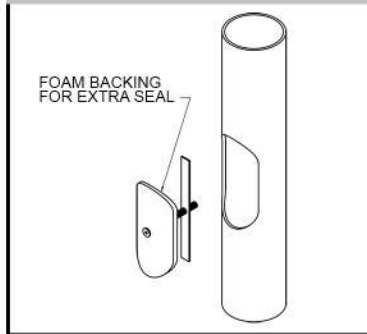

### TENON

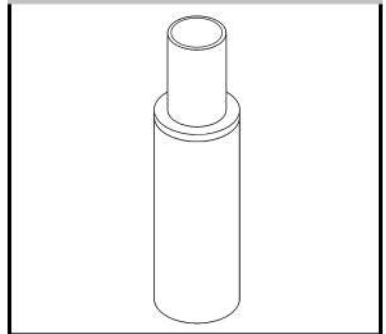

### DIRECT BURY

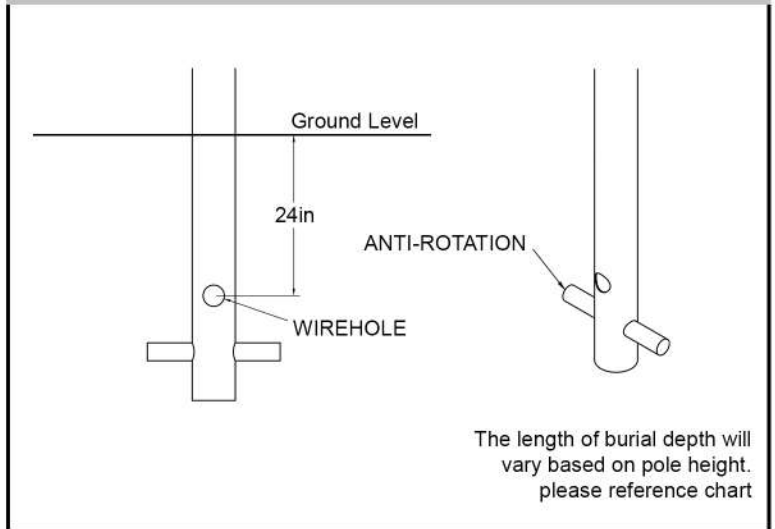

### SIDE MOUNT (not applicable when tenon opt. selected)

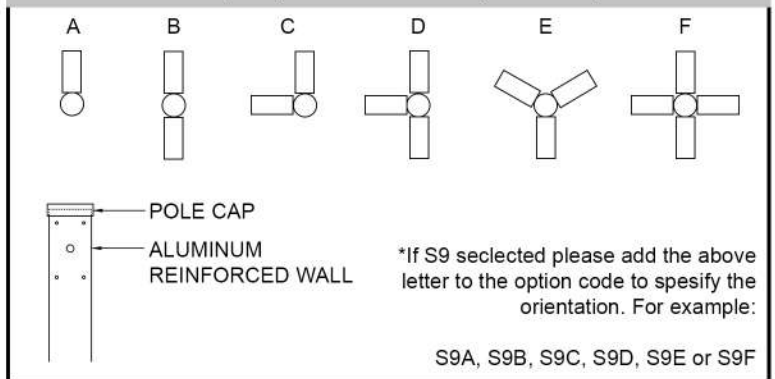

## ORDERING EXAMPLE

MODEL #	TENON MOUNT	SIDE MOUNT	COLOR	HANDHOLE	*F. HOLDER	*GFI	*SHROUD
(please reference charts for model #)	T4 - 2 3/8in x 4 5/8in T5 - 3in x 4 5/8in T7 - custom tenon  (leave blank if you selected a side mount)	S8 - reinforced side wall (no predrilling) S9* - reinforced side wall (with predrilling)  (leave blank if you selected a tenon mount)	BLK - black BR - bronze WH - white GR - gray CM - color match	H0 - no handhole H2 - 2 1/2in x 5in H3 - 4in x 6in CH - custom handhole	FLH - flag holder  (leave blank if you do not want this option)	GFI - standard Ground Fault Circuit Interrupter GFUI - in use Ground Fault Circuit Interrupter  (leave blank if you do not want this option)	1SH - one piece shroud 2SH - two piece shroud  (leave blank if you do not want this option)
D1015	T4	...	BLK	H2	...	GFI	...
If T7,S9,CM,CH,GFI or GFUI selected please call for further instructions			<b>= D1015-T4-BLK-H2-GFI</b>		*See accessories pages for info on F. Holder, GFI, and Shroud		

MODEL #	SHAFT LENGTH (FT)	MOUNTING HEIGHT (FT)	TIP OUTER Ø (IN)	GROUND LEVEL Ø (IN)	BURIAL DEPTH (FT)	NOMINAL WEIGHT (LBS)	10 EPA MAX (MPH)
D1015	19	15	5.3	8	4	53	100
D1020	24	20	5.3	8	4	68	100
D1025	30	25	5.3	8.25	5	111	100
D1030	35	30	5.3	8.5	5	130	100
D1035	40	35	5.3	8.5	5	163	100
D1040	45	40	5.3	8.5	5	239	100